

## INSTALLATION GUIDE - HYDRA® SAM 1,5 WALL

### INTRODUCTION

HyDra® Sam 1,5 Wall is a self-adhesive, post-applied bitumen membrane for waterproofing and radon protection of concrete constructions.

The membrane is delivered in 15 m<sup>2</sup> rolls. The membrane is equipped with a 25 mm bitumen strip to ensure an optimal adherence in overlaps.

The membrane is also equipped with “guidelines” for overlap to ensure a correct and efficient appliance.

#### Remember accessories:

- HyDra® Sam Tape
- HyDra® Sam Corner Tape
- HyDra® Sam Primer
- HyDra® Swelling Paste SX 100
- HyDra® Sealant

### PREPARATION BEFORE INSTALLATION

- The substructure must be dry, plane and without traces of oil, grease or like substances.
- Irregularities < 5 mm can be corrected with HyDra® 1K Svindfri.
- Irregularities > 5 mm can be corrected with appropriate repair mortar such as Redirep 45.
- Internal corners are rounded off with a chamfer with Redirep 45 or similar, external edges should be rounded.
- The substructure must be primed prior to application with HyDra® Sam Primer (ca. 0,15-0,25 l/m<sup>2</sup>)
- Both HyDra® Sam 1,5 Wall and HyDra® Sam Primer can be applied at temperatures between -5°C to +30°C.
- When applying HyDra® Sam Primer it will be white. It is important that the application of the membrane is not started until the primer becomes transparent and the surface is sticky. The time is dependent on temperature and humidity. However, the membrane must not be applied later than 24 hours after the primer has been applied. If more than 24 hours pass, the primer must be applied again.



Application of HyDra® Sam 1,5 Wall.

## INSTALLATIONS GUIDE - HYDRA® SAM 1,5 WALL

### INSTALLATION OF MEMBRANE AFTER THE APPLICATION OF THE HYDRA® SAM PRIMER

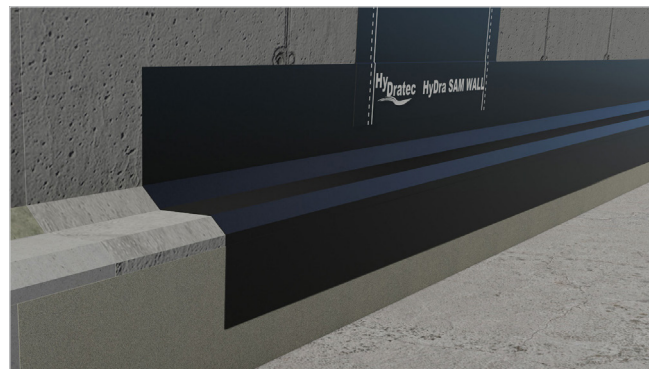
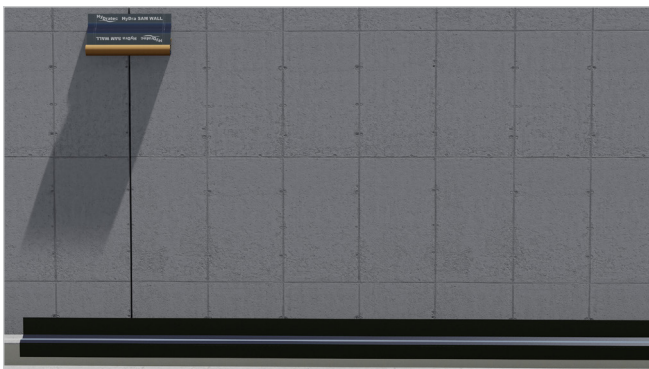

- Start by removing the protective foil and apply the HyDra® Sam 1,5 Wall along the joint between the slab and wall.
- Afterwards the membrane should be prepared and applied to the inner and outer corners. It is important that the inner and outer corners are applied correctly. Below is an example on how an inner corner (both top and bottom) can be made. The same technique is applied to the outer corners.
- Now apply the HyDra® Sam 1,5 Wall from the top of the wall.
- Press/roll the membrane unto the surface while the protective foil is removed gradually. Be aware of applying the membrane evenly and without air bubbles.
- Using a press roll when applying is recommended.
- Overlaps from the vertical to the horizontal membrane should be a minimum of 150 mm.



## INSTALLATION GUIDE - HYDRA® SAM 1,5 WALL

### EXAMPLE OF APPLICATION OF INNER CORNER – BOTTOM

● ● ● These colors are only used for a better illustration.

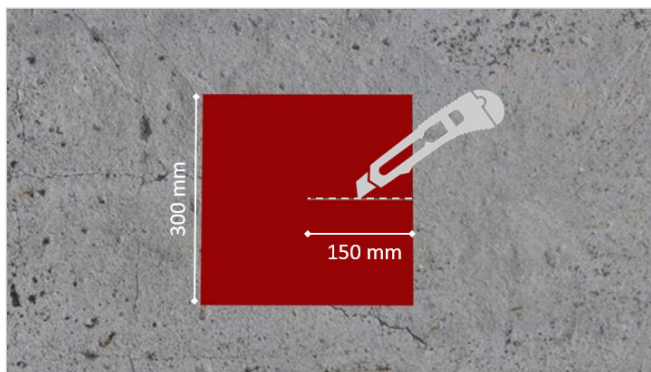

**1.** Cut a piece of Hydra® Sam 1,5 Wall of 300x300 mm.  
Then make a cut of 150 mm in the middle of the piece.

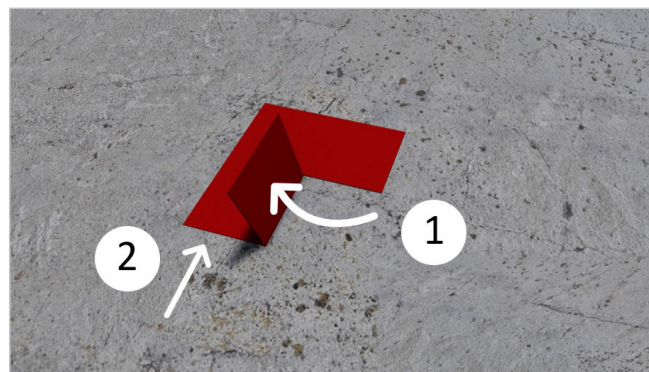

**2.** Fold the piece like the picture.

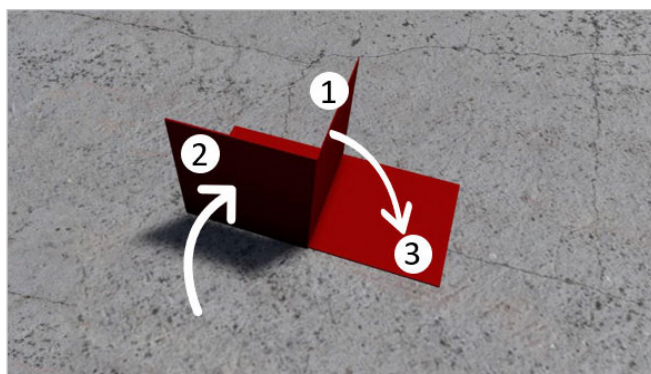

**2.1** Fold the piece like the picture.

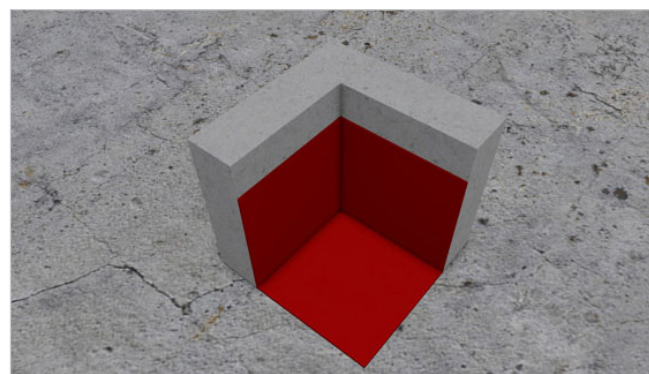

**3.** Place the finished corner in the bottom of the inner corner.

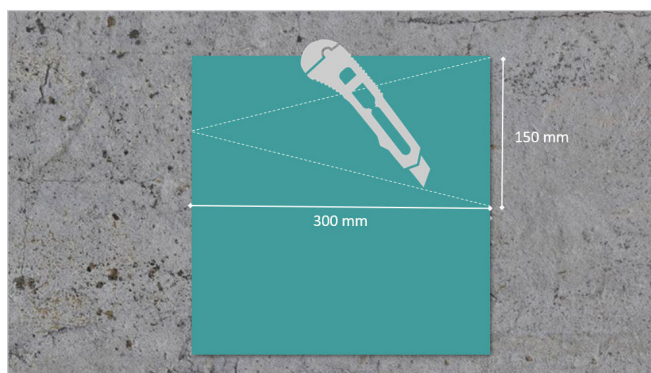

**4.** Cut a triangle of 300x150 mm.

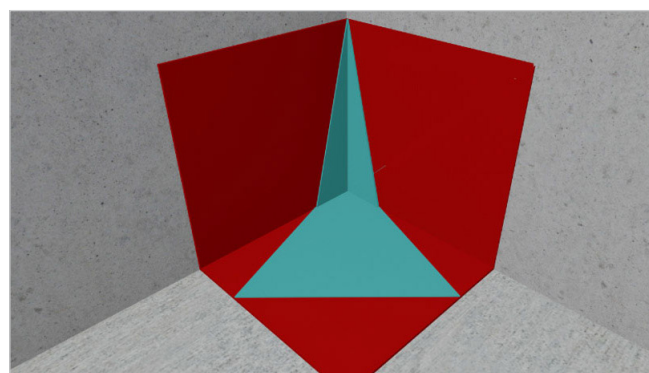

**5.** Place the piece of Hydra® Sam 1,5 Wall as shown on the picture.

## INSTALLATION GUIDE - HYDRA® SAM 1,5 WALL

### EXAMPLE OF APPLICATION OF INNER CORNER – TOP

 **These colors are only used for a better illustration.**

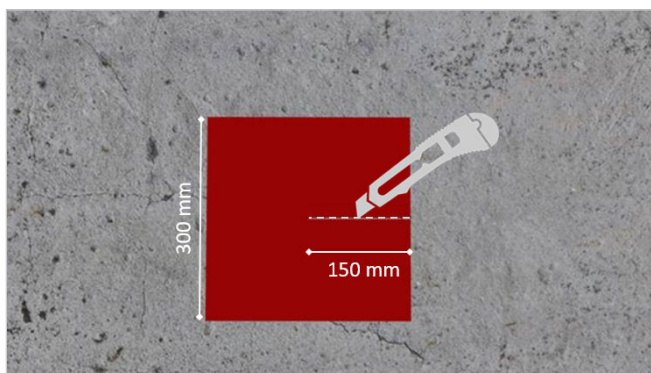

**1.** Cut a piece of Hydra® Sam 1,5 Wall of 300x300 mm.  
Then make a cut of 150 mm in the middle of the piece.

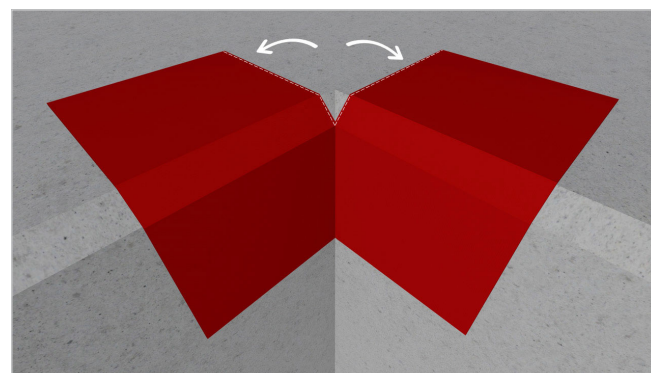

**2.** Apply the piece as shown on the picture.

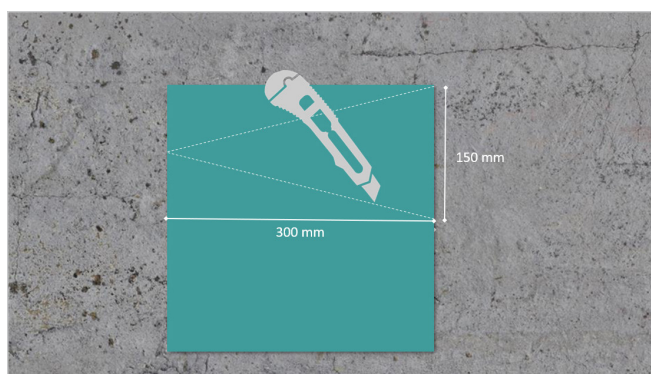

**3.** Cut a triangle of 300x150 mm.

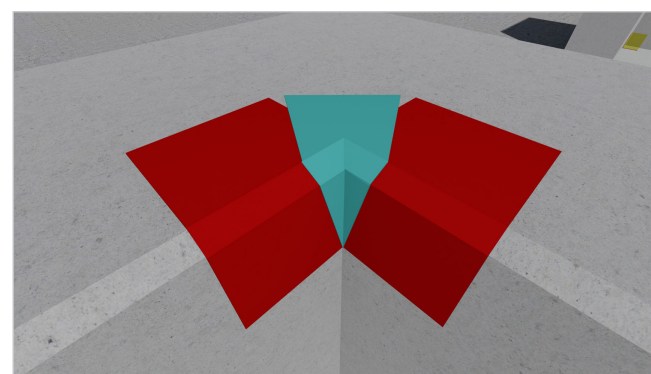

**4.** Place the triangle as shown in the picture.

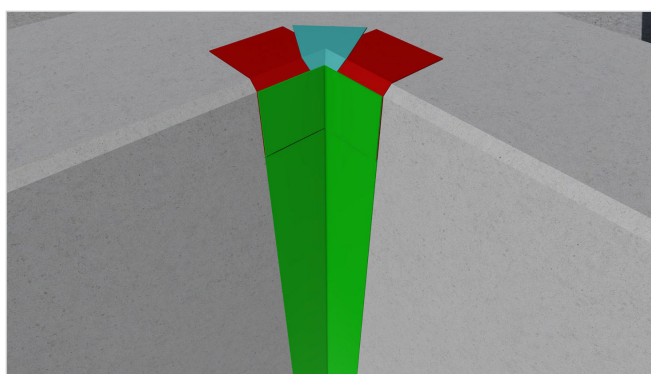

**5.** Apply the Hydra® Sam Corner Tape.

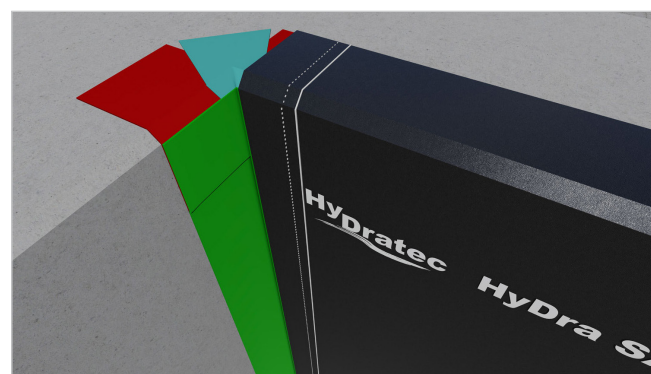

**6.** Afterwards the membrane can be applied.